

SPARKLING

| | | | |
|---|---|--|-----|
| CHANDON <i>brut</i> california (187 ml split) | | | 11 |
| ZONIN <i>prosecco</i> veneto, italy | 8 | | 32 |
| LE GRAND COURTÂGE “grande cuvée” <i>blanc de blanc</i> france | | | 49 |
| VEUVE CLICQUOT “yellow label” <i>brut</i> reims, france (375 ml half bottle) | | | 54 |
| VEUVE CLICQUOT “yellow label” <i>brut</i> reims, france | | | 108 |

WHITES

| | | | |
|---|----|----|-----|
| NOBILO <i>sauvignon blanc</i> marlborough, new zealand | 8 | 16 | 32 |
| VIÑA MAIPO “vitral” <i>sauvignon blanc</i> valle casablanca, chile | 10 | 20 | 40 |
| MATANZAS CREEK <i>sauvignon blanc</i> sonoma county | 12 | 24 | 48 |
| BUGLIONI “il disperato” <i>garganega</i> veneto, italy | 11 | 22 | 44 |
| CAMPANILLE <i>pinot grigio</i> friuli, italy | 8 | 16 | 32 |
| SCARPETTA <i>pinot grigio</i> delle venezie, italy | 11 | 22 | 44 |
| CLEAN SLATE <i>riesling</i> mosel, germany | 9 | 18 | 36 |
| PISONI FAMILY WINES “LUCY” <i>rose of pinot noir</i> santa lucia highlands | 10 | 20 | 40 |
| VINA ROBLES “estate” <i>vermentino</i> paso robles | 10 | 20 | 40 |
| WOLFGANG “concerto” <i>grüner veltliner</i> austria | 11 | 22 | 44 |
| J VINEYARDS <i>pinot gris</i> california | 10 | 20 | 40 |
| MARTIN CODAX <i>albariño</i> rías biaxas, spain | 10 | 20 | 40 |
| KETTMEIR <i>müller thurgau</i> alto adige, italy | 11 | 22 | 44 |
| STOLPMAN <i>roussanne</i> santa ynez | 12 | 24 | 48 |
| CLENDENEN FAMILY VINEYARDS <i>aligoté</i> santa maria valley | | | 56 |
| HESS “select” <i>chardonnay</i> monterey | 8 | 16 | 32 |
| KENDALL-JACKSON “vintner's reserve” <i>chardonnay</i> california | 9 | 18 | 36 |
| BENCHMARC CELLARS “estate” <i>chardonnay</i> suisun valley | 10 | 20 | 40 |
| SMOKEPOINT <i>chardonnay</i> santa barbara | 12 | 24 | 48 |
| RODNEY STRONG “chalk hill” <i>chardonnay</i> sonoma county | | | 44 |
| LA CREMA <i>chardonnay</i> monterey | | | 50 |
| SONOMA - CUTRER <i>chardonnay</i> russian river ranches | | | 52 |
| HARTFORD COURT <i>chardonnay</i> russian river valley | 15 | 30 | 60 |
| CAKEBREAD <i>chardonnay</i> napa valley | | | 75 |
| FLOWERS <i>chardonnay</i> sonoma coast | | | 84 |
| KISTLER “les noisetiers” <i>chardonnay</i> sonoma coast | | | 119 |
| WAYFARER <i>chardonnay</i> “fort ross-seaview” sonoma county | | | 128 |

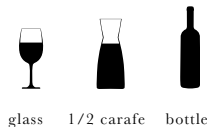
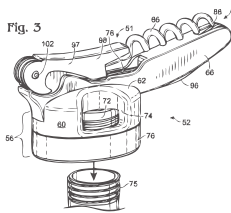

REDS

| | | | |
|---|----|----|-----|
| NIELSON by BYRON <i>pinot noir</i> santa barbara county | 11 | 22 | 44 |
| LYRIC by ETUDE <i>pinot noir</i> santa barbara | | | 46 |
| TALBOTT "kali hart" <i>pinot noir</i> monterey | 13 | 26 | 52 |
| DAVIS BYNUM "jane's vineyard" <i>pinot noir</i> russian river, sonoma county | | | 52 |
| SUMMERLAND <i>pinot noir</i> "bien nacido vineyard" santa maria valley | | | 68 |
| DECOY by DUCKHORN <i>pinot noir</i> sonoma county | 14 | 28 | 56 |
| BONACCORSI "j.l. bonaccorsi" <i>pinot noir</i> santa barbara | 15 | 30 | 60 |
| SMOKEPOINT <i>pinot noir</i> edna valley | 16 | 32 | 64 |
| SOKOL BLOSSER <i>pinot noir</i> dundee hills, oregon | | | 75 |
| SCAR OF THE SEA <i>pinot noir</i> santa barbara | | | 84 |
| EN ROUTE by FAR NIENTE <i>pinot noir</i> "les pommiers" russian river, sonoma county | | | 98 |
| WAYFARER <i>pinot noir</i> "fort ross-seaview" sonoma county | | | 156 |
| DuMOL <i>pinot noir</i> russian river valley, sonoma county | | | 160 |
| ALEXANDER VALLEY VINEYARDS <i>merlot</i> sonoma county | 12 | 24 | 48 |
| CLARENDELLE inspired by haut-brion <i>bordeaux</i> france | | | 52 |
| ADOBE GUADALUPE "gabriel" <i>bordeaux blend</i> Valle de Guadalupe, Mexico | | | 82 |
| TERRAZAS "altos del plata" <i>malbec</i> mendoza, argentina | 9 | 18 | 36 |
| TENUTA DI ARCENO <i>chianti classico</i> tuscan, italy | 11 | 22 | 44 |
| TURLEY <i>zinfandel</i> california | 16 | 32 | 64 |
| LOCATIONS "E" by DAVE PHINNEY <i>tempranillo-garnacha</i> spain | 11 | 22 | 44 |
| AUSTIN HOPE "troublemaker" <i>syrah blend</i> paso robles | 12 | 24 | 48 |
| SANS LIEGE "the offering" <i>grenache syrah mourvedre</i> santa barbara | | | 52 |
| TREANA <i>proprietary red</i> paso robles | 18 | 36 | 72 |
| THE PRISONER WINE COMPANY "the prisoner" <i>proprietary red</i> napa valley | 20 | 40 | 80 |
| PARADUXX by DUCKHORN <i>proprietary red</i> napa valley | | | 89 |
| SYMMETRY <i>proprietary red</i> alexander valley sonoma county | | | 99 |
| OVERTURE by OPUS ONE <i>proprietary red</i> napa valley | | | 178 |
| TOLOSA <i>cabernet sauvignon</i> paso robles | 12 | 24 | 48 |
| JUSTIN <i>cabernet sauvignon</i> paso robles | 15 | 30 | 60 |
| GROTH <i>cabernet sauvignon</i> oakville, napa valley | | | 85 |
| STAG'S LEAP WINE CELLARS "artemis" <i>cabernet sauvignon</i> napa valley | | | 86 |
| CHATEAU MONTELENA <i>cabernet sauvignon</i> napa valley | | | 89 |
| JORDAN <i>cabernet sauvignon</i> alexander valley, sonoma county | | | 92 |
| TOYBOX <i>cabernet sauvignon</i> st. helena, napa valley | | | 115 |
| CADE "howell mountain estate" <i>cabernet sauvignon</i> napa valley | | | 175 |

\$20 corkage charge per 750ml bottle of wine brought into the restaurant.

Maximum of two 750ml bottles per reservation.